

RESIDENCE 05C

INTERIOR	EXTERIOR
8,930 F ²	2,727 F ²
830 M ²	254 M ²

TOTAL
11,657 F²
1,084 M²

*

- 6 BEDROOMS

8 BATHROOMS

2 POWDER ROOMS

FAMILY ROOM

LIBRARY

OFFICE
- SERVICE SUITE

WINE ROOM

EXERCISE ROOM

GAME ROOM

GREAT ROOM

OCEAN VIEW

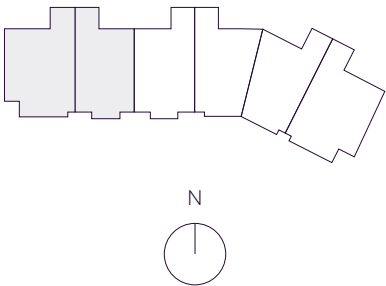

THE RESIDENCES
SIX FISHER ISLAND

6

6 Fisher Island Drive, Fisher Island, FL 33109
305.873.3852 — 6-fisherisland.com

DouglasElliman
Development Marketing

The dimensions stated for this floor plan are approximate because there are various recognized methods for calculating the square footage of a unit. The square footage stated here is calculated from the exterior boundaries of the exterior walls to the centerline of interior demising walls without deductions for cutouts, curves, or architectural features. This method typically results in quoted dimensions greater than the dimensions that would be determined by using other accepted methods. The definition of "Unit" and the calculation method to be relied upon is set forth by the Developer in Developer's prospectus which method may result in a square footage calculation less than the result of the calculation method used here. Dimension and unit configuration is not guaranteed and may change during construction. Depictions of furnishings, fixtures and other items of personal property are not included with purchase. Consult the Developer's prospectus to understand Unit dimensions, to learn what is included with purchase and by payment of regular condominium assessments, and to learn all terms and conditions. 2023 © PRH Parcel 7 Owner, LLC, with all rights reserved.

- BALCONY
100'-9" x 14'-8"
- FAMILY ROOM
22' x 18'
- BALCONY
15' x 33'-7"
- PRIMARY BEDROOM
17'-7" x 20'
- GREAT ROOM
52'-5" x 29'-7"
- HER BATHROOM
13'-3" x 11'
- KITCHEN
20' x 27'-4"
- EXERCISE ROOM
13'-11" x 27'-5"
- HIS BATHROOM
13'-3" x 11'
- HER WARDROBE
12'-8" x 11'-5"
- BALCONY
93'-4" x 6'-4"
- HIS WARDROBE
12'-6" x 11'-5"
- LIBRARY
11'-5" x 12'-5"
- WINE ROOM
11'-4" x 11'-3"
- OFFICE
12' x 12'
- GAME ROOM
14'-10" x 11'
- BEDROOM 2
24'-6" x 17'-4"
- BEDROOM 3
12'-10" x 14'-6"
- BEDROOM 4
14' x 12'
- BEDROOM 5
22'-5" x 16'-11"
- BEDROOM 6
14'-8" x 13'-4"
- FAMILY ROOM
22' x 18'
- BALCONY
19'-7" x 14'
- BALCONY
105'-5" x 13'-8"

N 25° 45.8255



*

W 80° 8.4428