

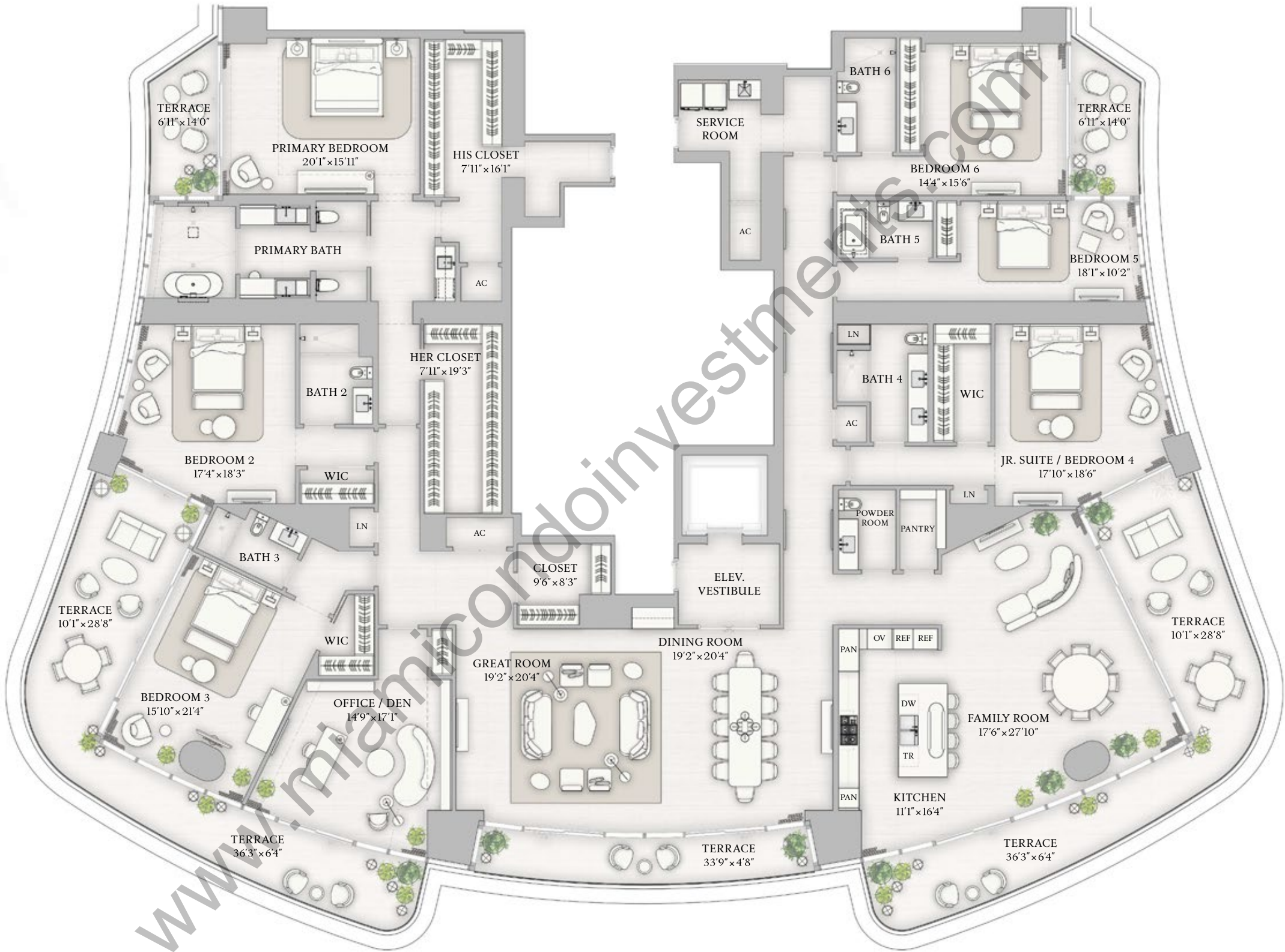

PENTHOUSE  
MPH C  
FLOOR 47

INTERIOR  
6,835 SF | 635 SQM  
EXTERIOR  
1,335 SF | 124 SQM

- 6 BEDROOMS
- 6 BATHROOMS
- POWDER ROOM
- OFFICE
- EAT-IN KITCHEN AND FAMILY ROOM



The dimensions stated for this Unit floor plan are approximate because there are various recognized methods for calculating the square footage of a Unit. The square footage stated here is calculated from the exterior boundaries of the exterior walls to the centerline of interior demising walls without deductions for cutouts, curves, or architectural features. This method typically results in quoted dimensions greater than the dimensions that would be determined by using other accepted methods. The definition of "Unit" and the calculation method to be relied upon is set forth in Developer's prospectus and the method set forth in the Developer's prospectus may result in a square footage calculation less than the method used here. Dimensions and Unit configuration may change during construction. The furniture illustrated is not included with purchase; the floorplan layout is not a guarantee on your use of space but is one example of uses of space. Consult the Developer's prospectus to understand the calculation of the Unit square footage and dimensions and what is included with purchase. Prices are not based on the square footage no matter the method of calculation of Unit dimensions and all prices are subject to change at any time.

BRICKELL AVE

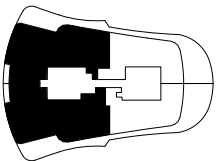

BISCAYNE BAY