

ICON

residence D

3 bedrooms, 3 baths
2,158 sq. ft. 200.40 m²
358 sq. ft. 33.25 m² balcony
2,516 sq. ft. 233.65 m² total

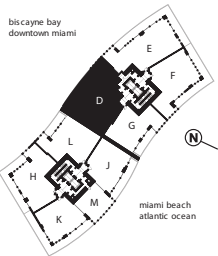

building amenities

- + philippe starck designed common areas
- + billiard room
- + heated lap pool
- + heated infinity-edged pool
- + café
- + conference room
- + spa
- + concierge services
- + valet parking

residences amenities

- + kitchens featuring marble or granite counter tops, imported european custom cabinetry, Miele® appliances and Sub-Zero® built-in refrigerator-freezer
- + master bathrooms furnished with european cabinetry, marble or granite counter tops, Philippe Starck fixtures and seamless shower enclosures
- + spacious walk-in closets
- + wiring for high-speed cable modem internet service
- + 9' high smooth ceilings

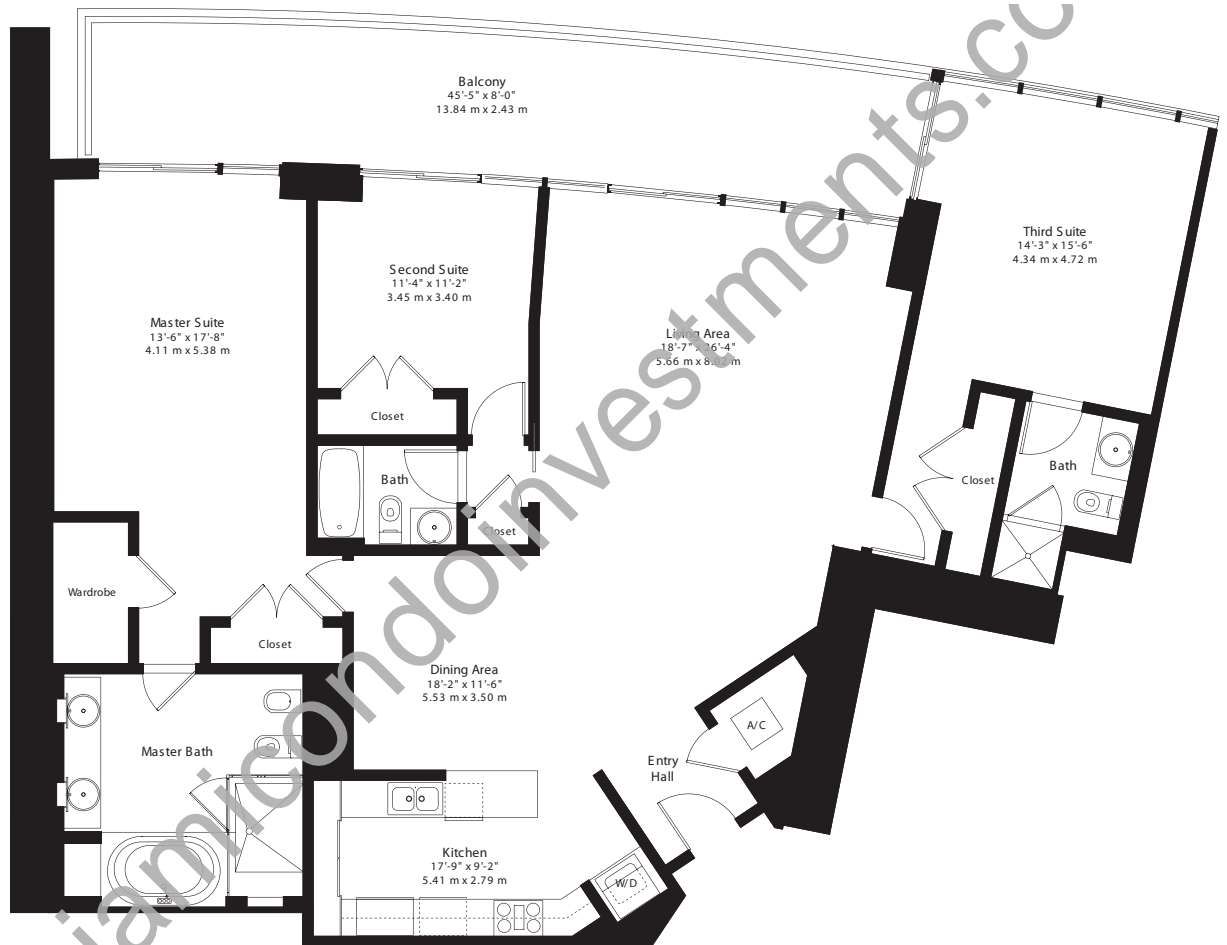

Note: All dimensions are approximate and all floor and development plans are subject to change without notice.