

BEACH



PENTHOUSE

16TH & 17TH FLOORS / DUPLEX

4+ BEDROOMS / 5 BATHROOMS / 2 POWDER ROOMS
PRIVATE ELEVATOR TO ROOFTOP POOL / OUTDOOR
KITCHENETTE

Total Living: 18,253 Sq Ft / 1,695.8 Sq M
Indoor: 8,273 Sq Ft / 768.6 Sq M
Alero: 7,299 Sq Ft / 678.1 Sq M
Private Rooftop with Pool: 2,681 Sq Ft / 249.1 Sq M

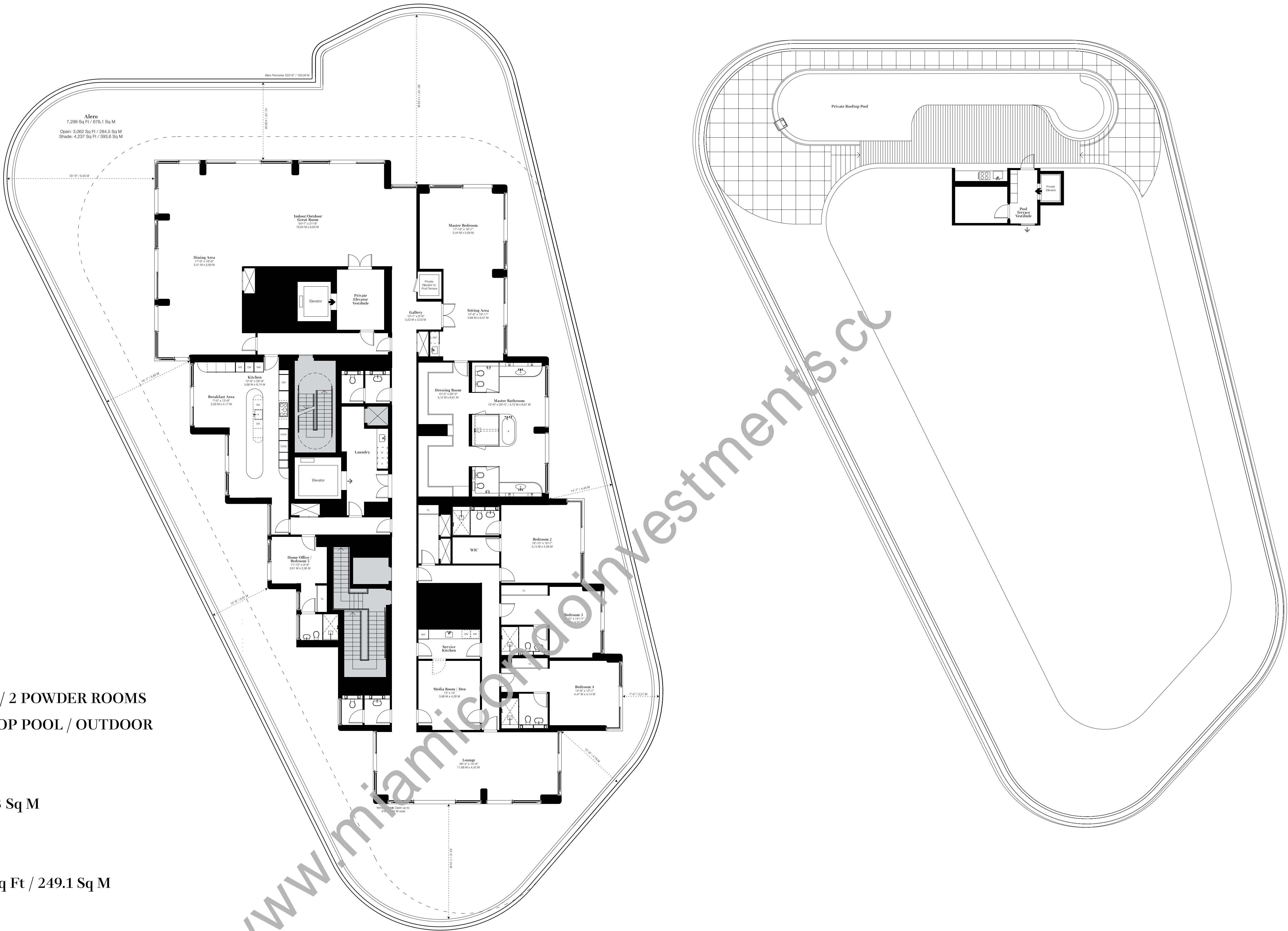

BAY

This is not an offer to sell, or solicitation of offers to buy, the condominium units in states where such offer or solicitation cannot be made. This offering is made only by the offering documents for the condominium, and no statement should be relied upon if not made in the offering documents. Stated dimensions are measured to the exterior boundaries of the exterior walls and the centerline of interior structural walls and do not vary from the dimensions that would be determined by using the description and definition of the "Gross" set forth in the Declaration (which generally only includes the interior square footage between the perimeter walls and excludes interior structural components). For your reference, the area of this Unit, determined in accordance with those defined unit boundaries, is 7,498 sq. ft. Note that measurements of homes set forth on the floor plans are generally taken at the greatest points of each room and the room areas are perfect rectangles, without regard for any columns. Accordingly, the area of this actual room will typically be smaller than the product obtained by multiplying the stated length times width. All dimensions are approximate and may vary with actual construction, and all floor plans and development plans are subject to change.